

BrightLine Angle LED lamp

(40°, Viewing angle 120°)

- ⑩ Lamp angle 40°
- ⑩ LED beam 120°
- ⑩ Isolation class IP61
- ⑩ Diffuse LED lens
- ⑩ Usable for 12V and 24V battery systems
- ⑩ Max length 2020mm



The BLA LED lamp is designed for situations where a 40° beam angle is needed.

Applications

- ⑩ Indication light
- ⑩ Indoor displays
- ⑩ Automotive
- ⑩ Cabinet lighting

Partnumber: BLA mmmm – 120 – vvT

mmmm is length in mm

120 is number of LEDs per meter

vv is Voltage (12V or 24V)

T is color temperature

W => 6000-7000K 1000-1300mcd

NW => 4000-5000K 1000-1300mcd

WW => 3000K 1000-1300mcd

LED type 3528

Connection cable 2mm² 2x0,75mm black, length 200cm

Profile casing Aluminium anodised blanc 20μ, 40° angle

Cover Acryl Satine 2mm diffuse

Length variable at 5cm interval added to 2cm of cable mount.

Dimensions section

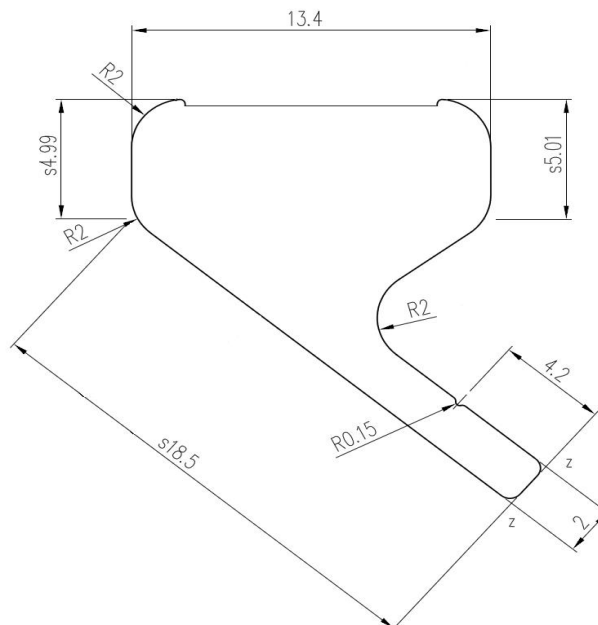

Do not look directly at LED with unshielded eyes or damage at retina may occur.

RoHS
COMPLIANT